

Gleitlager und Metallverarbeitung GmbH Osterwieck



Bronze bearings and aluminium - tin thrust washers (stop disks)

Castings

The production of the materials is effected in our own foundry, from the charge make-up (burden calculation) of the alloy components via the melting process up to the potting. High-strength materials can be produced by the introduction of new casting and moulding technologies.

MATERIALS

- aluminium alloys
(for example AlSn / AlSi)
- copper alloys
(for example lead / tin bronzes)

TYPES OF BEARINGS

- half-shells with / without collar
- bearing bushes with / without collar
- thrust bushings separated / unseparated
- linear sliding surfaces and sliding segments
- special parts



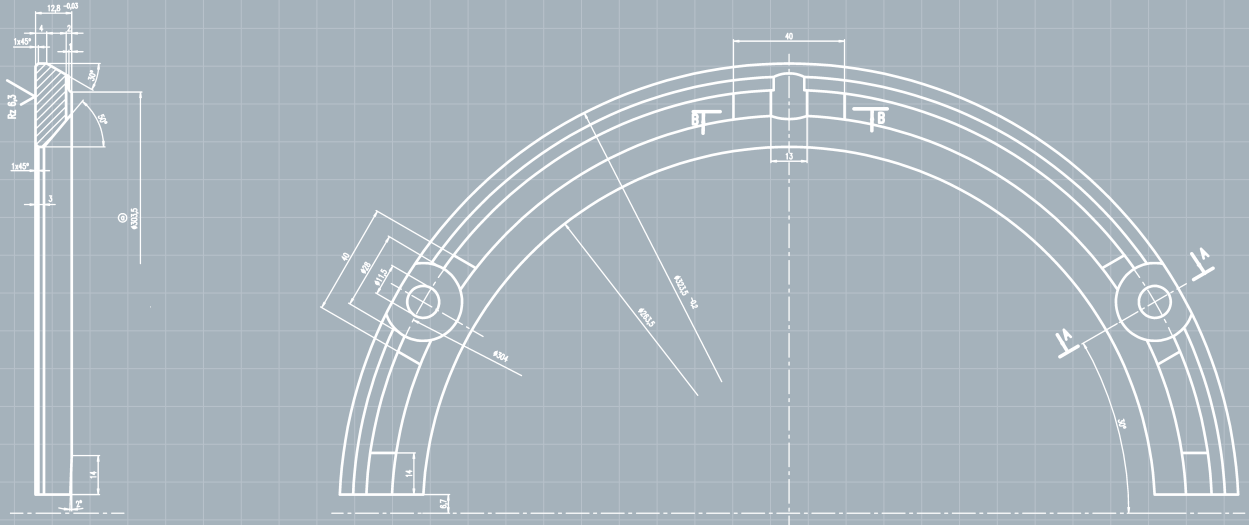
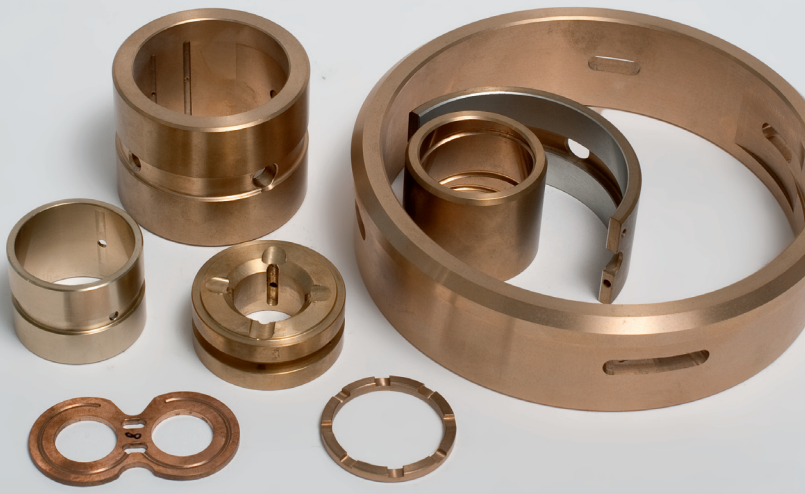

Massive parts for various possibilities of application

Castings

The manufacture of raw parts is effected by stove and die casting as well as by squeeze casting procedure. Furthermore, we manufacture bronze granulate in different versions.

The further processing is effected by means of modern CNC turning and milling technology in compliance with the quality safety system of ISO 9001/14001.

CHARACTERISTICS

- free of porosity and bubbles
- high strength
- long service life
- optimum emergency running properties

Contact

Gleitlager und Metallverarbeitung GmbH Osterwieck | Ziegeleiweg 3 | 38835 Osterwieck
 Phone: +49(0) 39421/61970 | Fax: +49(0) 39421/6197-130 | Email: info@gmo-gleitlager.de

